

BEFORE THE ILLINOIS POLLUTION CONTROL BOARD

Deborah Ann Rousoneles)
(Property Identification Number) PCB 012-
08-003-005-02) (Tax Certification)
)

NOTICE

Clerk
Illinois Pollution Control Board
James R. Thompson Center
100 West Randolph Street, Suite. 11-500
Chicago, Illinois 60601

Deborah Ann Rousoneles
25925 W. 135th Street
Plainfield, Illinois 60544

Steve Santarelli
Illinois Department of Revenue
101 West Jefferson
Post Office Box 19033
Springfield, Illinois 62794

PLEASE TAKE NOTICE that I have today filed with the Office of the Clerk of the Pollution Control Board an **APPEARANCE AND THE RECOMMENDATION** of the Illinois Environmental Protection Agency, a copy of which is herewith served upon you.

ILLINOIS ENVIRONMENTAL PROTECTION
AGENCY

By: Vera Herst
Vera Herst
Assistant Counsel
Division of Legal Counsel

DATED: August 25, 2011

Illinois Environmental Protection Agency
1021 North Grand Avenue East
Post Office Box 19276
Springfield, Illinois 62794-9276
(217) 782-5544

THIS FILING IS SUBMITTED ON RECYCLED PAPER

BEFORE THE ILLINOIS POLLUTION CONTROL BOARD

Deborah Ann Rousoneles
(Property Identification Number
08-003-005-02)

)
) PCB 012-
) (Tax Certification)
)

A P P E A R A N C E

The undersigned, as one of its attorneys, hereby enters an APPEARANCE on behalf of Respondent,
Illinois Environmental Protection Agency.

ILLINOIS ENVIRONMENTAL PROTECTION AGENCY

By: Vera Horst
Vera Horst
Assistant Counsel
Division of Legal Counsel

DATED: August 25, 2011
Illinois Environmental Protection Agency
1021 North Grand Avenue East
Post Office Box 19276
Springfield, Illinois 62794-9276
(217)782-5544

THIS FILING IS SUBMITTED ON RECYCLED PAPER

BEFORE THE ILLINOIS POLLUTION CONTROL BOARD

Deborah Ann Rousoneles)
(Property Identification Number) PCB 012-
08-003-005-02) (Tax Certification)
)

RECOMMENDATION

The Illinois Environmental Protection Agency ("Illinois EPA") hereby files its Recommendation pursuant to Section 125.204 of the regulations of the Illinois Pollution Control Board, 35 Ill. Adm. Code 125.204.

1. On April 27, 2010, the Illinois EPA received a request from Deborah Ann Rousoneles (log number TC-05-11, Exhibit A) for an Illinois EPA recommendation regarding the tax certification of water pollution control facilities pursuant to 35 Ill. Adm. Code 125.204.

2. The applicant's address is: Deborah Ann Rousoneles
P.O. Box 211
Stronghurst, Illinois 61480

3. The proposed water pollution control facilities in this request are located at Section 3, T9N, R5W of the 4th PM in Henderson County, at the above street address and consist of the following:

Livestock waste management facilities consisting of one concrete manure pit approximately (28 ft. x 71 ft. x 8 ft. deep) with 4 concrete pump out pits approximately (6 ft. x 6 ft. x 8 ft. deep) and the portion of coated wire flooring over the manure pit in building #1.

These livestock waste management facilities are used to collect, transport and/or store livestock wastes prior to cropland application, and are further described in Exhibit A.

4. Section 11-10 of the Property Tax Code, 35 ILCS 200/11-10 (2010), defines "pollution control facilities" as:

"any system, method, construction, device or appliance appurtenant thereto or any portion of any building or equipment, that is designed, constructed, installed or operated for the primary purpose of: (a) eliminating, preventing, or reducing air or water pollution ...or (b) treating, pretreating, modifying or disposing of any potential solid, liquid or gaseous pollutant which if released without treatment, pretreatment modification or

THIS FILING IS SUBMITTED ON RECYCLED PAPER

disposal might be harmful, detrimental or offensive to human, plant or animal life, or to property.”

5. Pollution control facilities are entitled to preferential tax treatment, 35 ILCS 200/11-5.

6. Based on the information in the application and the purpose of the facilities, it is the Illinois EPA’s engineering judgment that the described facilities may be considered “pollution control facilities,” pursuant to 35 Ill. Adm. Code 125.200(a), with the primary purpose of eliminating, preventing, or reducing water pollution, or as otherwise provided in 35 Ill. Adm. Code 125.200, and are eligible for tax certification from the Board.

WHEREFORE, the Illinois EPA recommends that the Board issue the requested tax certification.

ILLINOIS ENVIRONMENTAL
PROTECTION AGENCY

By: Vera Herst
Vera Herst
Assistant Counsel
Division of Legal Counsel

Dated: August 25, 2011
Illinois Environmental Protection Agency
1021 North Grand Ave. E.
P.O. Box 19276
Springfield, Illinois 62794-9276
217/782-5544

THIS FILING IS SUBMITTED ON RECYCLED PAPER



*** RCB 2012 033 ***
ILLINOIS ENVIRONMENTAL PROTECTION AGENCY

1021 North Grand Avenue East, P.O. Box 19276, Springfield, Illinois 62794-9276 • (217) 782-2829
James R. Thompson Center, 100 West Randolph, Suite 11-300, Chicago, IL 60601 • (312) 814-6026

PAT QUINN, GOVERNOR

Memorandum

To: Connie Tonsor, Division of Legal Counsel

From: Al Keller, Manager, Permit Section *AK*

Date: August 18, 2011

Re: Deborah Ann Rousoneles - Plainfield
Recommendation of Tax Certification
Log # TC-05-11
Property Identification # 08-003-005-02

RECEIVED
Division of Legal Counsel

AUG 19 2011

Environmental Protection
Agency

The Bureau of Water received a request on June 27, 2011 from Deborah Ann Rousoneles for an Illinois EPA recommendation regarding the tax certification of water pollution control facilities pursuant to 35 Il. Adm. Code 125.204. We offer the following recommendation.

The water pollution control facilities in this request include the following:

Deborah Ann Rousoneles
P.O. Box 211
Stronghurst, IL 61480

Section 3, Township 9N, Range 5W of the 4th PM in Henderson County.

Livestock waste management facilities consisting of one concrete manure pit approximately (281 ft. x 71 ft. x 8 ft. deep) with 4 concrete pump out pits approximately (6 ft. x 6 ft. x 8 ft. deep) and the portion of slotted concrete flooring over the manure pits in building #1.

These livestock waste management facilities are used to collect, transport and/or store livestock wastes prior to cropland application.

These facilities are further described in the enclosed applications and supporting documents.

Based on the information included in this submittal, it is our engineering judgment that the above proposed facilities may be considered "Pollution Control Facilities" under 35 IAC 125.200(a), with the primary purpose of eliminating, preventing, or reducing water pollution, or as otherwise provided in this section, and therefore eligible for tax certification from the Illinois Pollution Control Board. The Bureau of Water therefore recommends that the Board issue the requested tax certification for these facilities.

If you have any questions regarding the above, please contact James Blessman at 217/782-0610.

SAK:JTB:TC-05-11_Tax Cert Recommendation_27Jun11.docx

cc: Tax Cert File

Rockford • 4302 N. Main St., Rockford, IL 61103 • (815) 987-7760

Elgin • 595 S. State, Elgin, IL 60123 • (847) 608-3131

Bureau of Land – Peoria • 7620 N. University St., Peoria, IL 61614 • (309) 693-5462

Collinsville • 2009 Mall Street, Collinsville, IL 62234 • (618) 346-5120

Des Plaines • 9511 W. Harrison St., Des Plaines, IL 60016 • (847) 294-4000

Peoria • 5415 N. University St., Peoria, IL 61614 • (309) 693-5463

Champaign • 2125 S. First St., Champaign, IL 61820 • (217) 278-5800

Marion • 2309 W. Main St., Suite 116, Marion, IL 62959 • (618) 993-7200

Project Review Notes

***** PCB 2012-033 *****

Reviewer: JTB

Date: Click here to enter a date.

8/16/11

Project Name Deborah Ann Rousoneles

Project Location Plainfield

County Henderson

Log No. TC-05-11

Project Description Livestock waste management facilities consisting of one concrete manure pits approximately (281 ft. x 71 ft. x 8 ft. deep) with 4 concrete pump out pits approximately (6 ft. x 6 ft. x 8 ft. deep) and the portion of slotted concrete flooring over the manure pits in building #1.

These livestock waste management facilities are used to collect, transport and/or store livestock wastes prior to cropland application.

0815 Spoke with Peter Rouseneles the flooring of the facility is slotted concrete. Facility was certified under Magy Farms.

Watershed Unit Tax Certification Review Sheet

Project Name: Deborah Ann Rousoneles

Location: Plainfield

Reviewer: JTB

Date: August 16, 2011

Log number: TC-05-11

Type: Agchem
 Livestock

Applicant: Deborah Ann Rousoneles
25925 W 135th St.
Plainfield, IL 60544

Contact: _

Phone: _

Facility: Deborah Ann Rousoneles
P.O. Box 211
Stronghurst, IL 61480

Property ID: 08-003-005-02

County: Henderson

Legal Description:
S: Section 3 Twp: 9N R: 5W PM: 4th

Signature: Deborah Ann Rousoneles

Title: Owner

Date Control Devices installed: 10/1/2007

Provided Fair cash Value: \$500,000

Wastes: Livestock waste is applied to cropland.
 Agrichemical rinsate and spillage is recycled through the facility and/or land applied.
 Other: _____

Physical Description of Pollution Control Devices:

Livestock waste management facilities consisting of one concrete manure pits approximately (281 ft. x 71 ft. x 8 ft. deep) with 4 concrete pump out pits approximately (6 ft. x 6 ft. x 8 ft. deep) and the portion of slotted concrete flooring over the manure pits in building #1.

These livestock waste management facilities are used to collect, transport and/or store livestock wastes prior to cropland application.

[7/14/2011 : on DLH inbox 1145]-[7/14/11 Logged in]



Electronic Filing - Received, Clerk's Office, 08/25/2011
ILLINOIS ENVIRONMENTAL PROTECTION AGENCY

1021 North Grand Avenue East, P.O. Box 19276, Springfield, Illinois 62794-9276 • (217) 782-2829
James R. Thompson Center, 100 West Randolph, Suite 11-300, Chicago, IL 60601 • (312) 814-6026

PAT QUINN, GOVERNOR

DOUGLAS P. SCOTT, DIRECTOR

Memorandum

To: Connie Tonsor, Division of Legal Counsel

From: Al Keller, Manager, Permit Section

Date:

Re: Rousoneles - Plainfield
Recommendation of Tax Certification
Log # TC-05-11
Property Identification # 08-003-005-02

Debra Ann

The Bureau of Water received a request on June 27, 2011 from Deborah Ann Rousoneles for an Illinois EPA recommendation regarding the tax certification of water pollution control facilities pursuant to 35 Il. Adm. Code 125.204. We offer the following recommendation.

The water pollution control facilities in this request include the following:

Rousoneles
P.O. Box 211
Stronghurst, IL 61480

Section 3, Township 9N, Range 5W of the 4th PM in Henderson County.

Livestock waste management facilities consisting of one concrete manure pit approximately (281 ft. x 71 ft. x 8 ft. deep) with 4 concrete pump out pits approximately (6 ft. x 6 ft. x 8 ft. deep) and the portion of coated wire flooring over the manure pit in building #1.

These livestock waste management facilities are used to collect, transport and/or store livestock wastes prior to cropland application.

These facilities are further described in the enclosed applications and supporting documents.

Based on the information included in this submittal, it is our engineering judgment that the above proposed facilities may be considered "Pollution Control Facilities" under 35 IAC 125.200(a), with the primary purpose of eliminating, preventing, or reducing water pollution, or as otherwise provided in this section, and therefore eligible for tax certification from the Illinois Pollution Control Board. The Bureau of Water therefore recommends that the Board issue the requested tax certification for these facilities.

If you have any questions regarding the above, please contact James Blessman at 217/782-0610.

SAK:JTB:TC-05-11_Tax Cert Recommendation_27Jun11.docx

cc: Tax Cert File

Rockford • 4302 N. Main St., Rockford, IL 61103 • (815) 987-7760

Elgin • 595 S. State, Elgin, IL 60123 • (847) 608-3131

Bureau of Land - Peoria • 7620 N. University St., Peoria, IL 61614 • (309) 693-5462

Collinsville • 2009 Mall Street, Collinsville, IL 62234 • (618) 346-5120

Des Plaines • 9511 W. Harmon St., Des Plaines, IL 60016 • (847) 294-4000

Peoria • 5415 N. University St., Peoria, IL 61614 • (309) 693-5463

Champaign • 2125 S. First St., Champaign, IL 61820 • (217) 278-5800

Marion • 2309 W. Main St., Suite 116, Marion, IL 62959 • (618) 993-7200

***** PCB 2012-033 *****
Watershed Unit Tax Certification Review Sheet

Project Name:

Location: Plainfield

Reviewer: JTB

Date: July 14, 2011

Log number: TC-05-11

Type: Agchem
 Livestock

Applicant: Deborah Ann Rousoneles
25925 W 135th St.
Plainfield, IL 60544

Contact: _

Phone: _

Facility:
P.O. Box 211
Stronghurst, IL 61480

Property ID: 08-003-005-02

County: Henderson

Legal Description:
S: Section 3 Twp: 9N R: 5W PM: 4th

Signature: Deborah Ann Rousoneles

Title: Owner

Date Control Devices installed: 10/1/2007

Provided Fair cash Value: \$500,000

Wastes: Livestock waste is applied to cropland.
 Agrichemical rinsate and spillage is recycled through the facility and/or land applied.
 Other: _____

Physical Description of Pollution Control Devices:

Livestock waste management facilities consisting of one concrete manure pit approximately (281 ft. x 71 ft. x 8 ft. deep) with 4 concrete pump out pits approximately (6 ft. x 6 ft. x 8 ft. deep) and the portion of coated wire flooring over the manure pit in building #1.

These livestock waste management facilities are used to collect, transport and/or store livestock wastes prior to cropland application.

[7/14/11 Logged in]

***** PCB 2012-033 *****

APPLICATION FOR CERTIFICATION (PROPERTY TAX TREATMENT)
 POLLUTION CONTROL FACILITY
 AIR WATER

ILLINOIS ENVIRONMENTAL PROTECTION AGENCY
 P. O. Box 19276, Springfield, IL 62794-9276

This Agency is authorized to request this information under Illinois Revised Statutes, 1979, Chapter, 120, Section 502a-5. Disclosure of this information is voluntary. However, failure to comply could prevent your application from being processed or could result in denial of your application for certification.

FOR AGENCY USE

File No.	Date Received	Certification No.	Date	
Sec. A APPLICANT	Company Name <i>Deborah Ann Rausoneles</i>			
	Person Authorized to Receive Certification <i>Deborah Ann Rausoneles</i>		Person to Contact for Additional Details <i>Peter Rausoneles</i>	
	Street Address <i>25925 W. 135th St.</i>		Street Address <i>P.O. Box 211</i>	
	Municipality, State & Zip Code <i>Plainfield, IL 60544</i>		Municipality, State & Zip Code <i>Stronghurst, IL 60480</i>	
	Telephone Number <i>815-715-6494</i>		Telephone Number <i>309-363-5358</i>	
	Location of Facility Quarter Section Township Range <i>SW Quarter 3 9 5</i>		Municipality Township <i>Stronghurst</i>	
	Street Address		County Book Number <i>Henderson 440 page 083</i>	
	Property Identification Number <i>08-003-005-02</i>		Parcel Number <i>Pollution control facility # 060-036-2428</i>	
	Sec. B MANUFACTURING OPERATIONS	Nature of Operations Conducted at the Above Location <i>Swine Production</i>		
		Water Pollution Control Construction Permit No.	Date Issued	
NPDES PERMIT No.		Date Issued	Expiration Date	
Air Pollution Control Construction Permit No.		Date Issued		
Air Pollution Control Operating Permit No.		Date Issued		
Sec. C MANUFACTURING PROCESS	Describe Unit Process RECEIVED JUN 27 2011			
	Materials Used in Process ILLINOIS ENVIRONMENTAL PROTECTION AGENCY BOW/WPC/PERMIT SECTION			
Sec. D POLLUTION CONTROL FACILITY DESCRIPTION	Describe Pollution Abatement Control Facility <ul style="list-style-type: none"> - Diagram Attached to Application - Dimension of Pit = 281'-4" x 71'-2" x 8' deep - Dimension of Pit Pump-outs = 6' x 6' x 8' deep (4 total) - All concrete construction 			

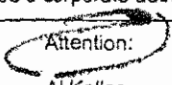
POLLUTION CONTROL FACILITY - CONTAMINANTS	Sec. E (1) Nature of Contaminants or Pollutants		
			Material Retained, Captured or Recovered
	Contaminant or Pollutant	DESCRIPTION	DISPOSAL OR USE
	Swine Manure	Swine Manure	Land Applied
ACCOUNTING DATA	(2) Point(s) of Waste Water Discharge		
	NONE		
	Plans and Specifications Attached		Yes <input type="checkbox"/> No <input type="checkbox"/>
	(3) Are contaminants (or residues) collected by the control facility?	Yes <input type="checkbox"/> No <input type="checkbox"/>	
	(4) Date installation completed	10/11/2007 status of installation on date of application Complete	
	(5) a. FAIR CASH VALUE IF CONSIDERED REAL PROPERTY:	\$ 500,000	
	b. NET SALVAGE VALUE IF CONSIDERED REAL PROPERTY:	\$	
	c. PRODUCTIVE GROSS ANNUAL INCOME OF CONTROL FACILITY:	\$	
	d. PRODUCTIVE NET ANNUAL INCOME OF CONTROL FACILITY:	\$	
	e. PERCENTAGE CONTROL FACILITY BEARS TO WHOLE FACILITY VALUE:	% 55%	
SIGNATURE	Sec. F The following information is submitted in accordance with the Illinois Property Tax Code, as amended, and to the best of my knowledge, is true and correct. The facilities claimed herein are "pollution control facilities" as defined in Section 11-10 of the Illinois Property Tax Code.		
	 OWNER		
Signature			Title
INSTRUCTIONS	Sec. G INSTRUCTIONS FOR COMPILING AND FILING APPLICATION		
	General: Separate applications must be completed for each control facility claimed. Do not mix types (water and air). Where both air and water operations are related, file two applications. If attachments are needed, record them consecutively on an index sheet.		
	Sec. A	Information refers to applicant as listed in the tax records and the person to be contacted for further details or for inspection of facilities. Define facility location by street address or legal description. A plat map location is required for facilities located outside of municipal boundaries. The property identification number is required.	
	Sec. B	Self-explanatory. Submit copies of all permits issued by local pollution control agencies. (e.g. MSD Construction Permit)	
	Sec. C	Refers to manufacturing processes or materials on which pollution control facility is used.	
	Sec. D	Narrative description of the pollution control facility, indicating that its primary purpose is to eliminate, prevent or reduce pollution. State the type of control facility. State permit number, date, and agency issuing permit. A narrative description and a process flow diagram describing the pollution control facility. Include a listing of each major piece of equipment included in the claimed fair cash value for real property. Include an average analysis of the influent and effluent of the control facility stating the collection efficiency.	
	Sec. E	List air contaminants, or water pollution substances released as effluents to the manufacturing processes. List also the final disposal of any contaminants removed from the manufacturing processes. Item (1) - Refers to pollutants and contaminants removed from the process by the pollution control facility. Item (2) - Refers to water pollution but can apply to water-carried wastes from air pollution control facilities. Submit drawings, which clearly show (a) Point(s) of discharge to receiving stream, and (b) Sewers and process piping to and from the control facility. Item (3) - If the collected contaminants are disposed of other than as wastes, state the disposition of the materials, and the value in dollars reclaimed by sale or reuse of the collected substances. State the cost of reclamation and related expense. Item (4) - State the date which the pollution control facility was first placed in service and operated. If not, explain. Item (5) - This information is essential to the certification and assessment actions. This accounting data must be completed to activate project review prior to certification by this Agency.	
	Sec. F	Self-explanatory. Signature must be a corporate authorized signature.	
		Submit to:	Attention:
		Illinois EPA P.O. Box 19276 Springfield, IL 62794-9276	 Al Keller Permit Section Division of Water Pollution Control

- Pit and Pit Pump-Outs are Concrete Construction

Pit Depth = 8 feet

THE CONCRETE DRAWINGS UNITED BUILDERS ASSOCIATES L.L.C. HAS PROVIDED FOR THIS BARN SHOULD BE USED FOR NON-STRUCTURAL INFORMATION. (OVERALL DIMENSIONS OF THE BARN, COLUMN PLACEMENT, BOX-OUT LOCATIONS FOR FANS, ETC.)
FRANK & WEST HAVE ENGINEERED THIS BARN FOR THE ILLINOIS DEPARTMENT OF AGRICULTURE AND THEIR DRAWINGS SHOULD BE USED FOR THE STRUCTURAL INTEGRITY OF THE BARN. (REBAR SPACING, SIZE OF REBAR, FOOTING DEPTH, WALL THICKNESS, ETC.)

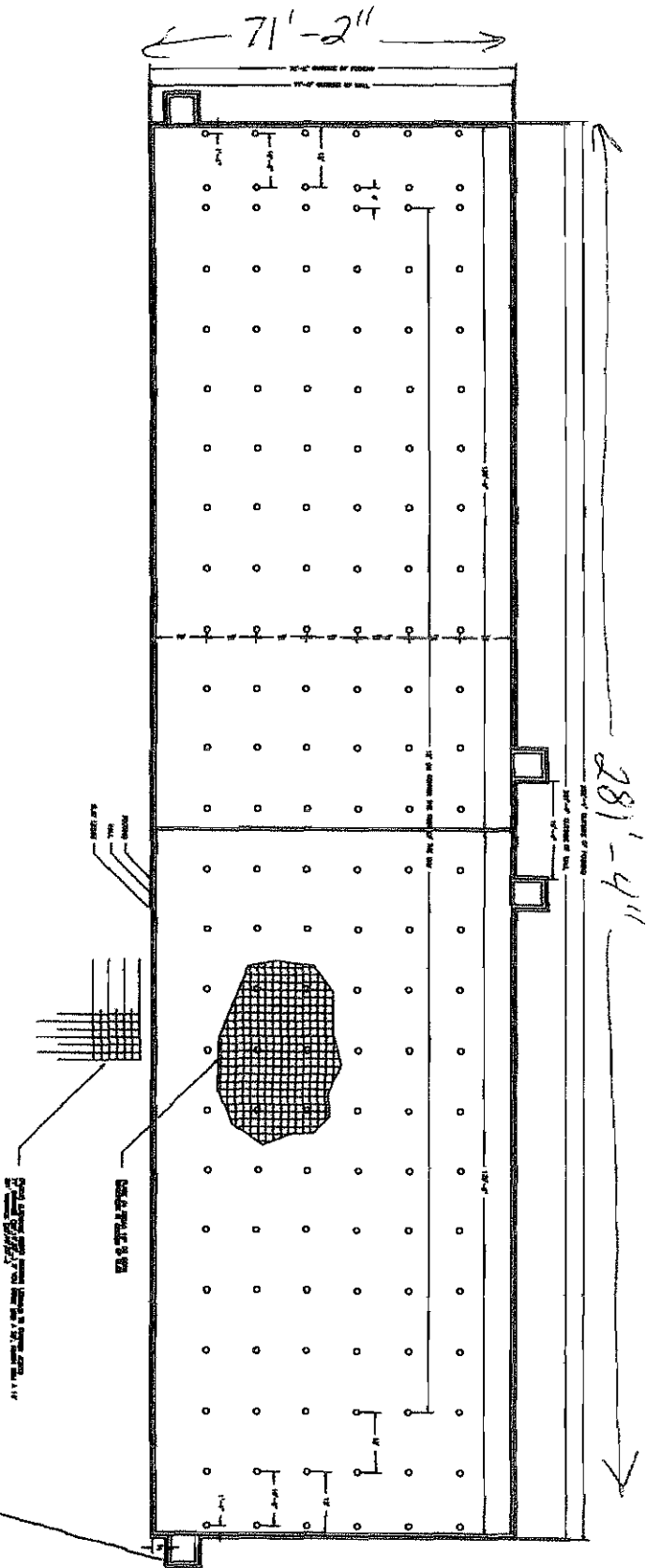

- Pit Pump-Out Dimensions
6' wide x 6' wide x 8' High
- 4 Pit Pump-Outs
locations

THESE DRAWINGS ARE THE PROPERTY OF UNITED BUILDERS ASSOCIATES L.L.C. ANY UNAUTHORIZED USE OF THE DESIGNS PRESENTED HERE IS STRICTLY PROHIBITED.

UNITED BUILDERS ASSOCIATES
2455 HILL
MADISON, IL 62205
PHONE (314) 653-2200

SYSTEM	DATE	REVISIONS	CONCRETE A
SCALE	DATE	REVISIONS	CONCRETE A
NO. 1	NO. 1	NO. 1	NO. 1
NO. 2	NO. 2	NO. 2	NO. 2

*****PCB 2012033*****
EARTH FACTS

FACT: Earth is gradually slowing down. Every few years, an extra second is added to make up for lost time. Millions of years ago, a day on Earth would have been 20 hours long. It is believed that, in millions of years time, a day on earth will be 27 hours long.

T-9-N

STRONGHURST PLAT

R-5-W

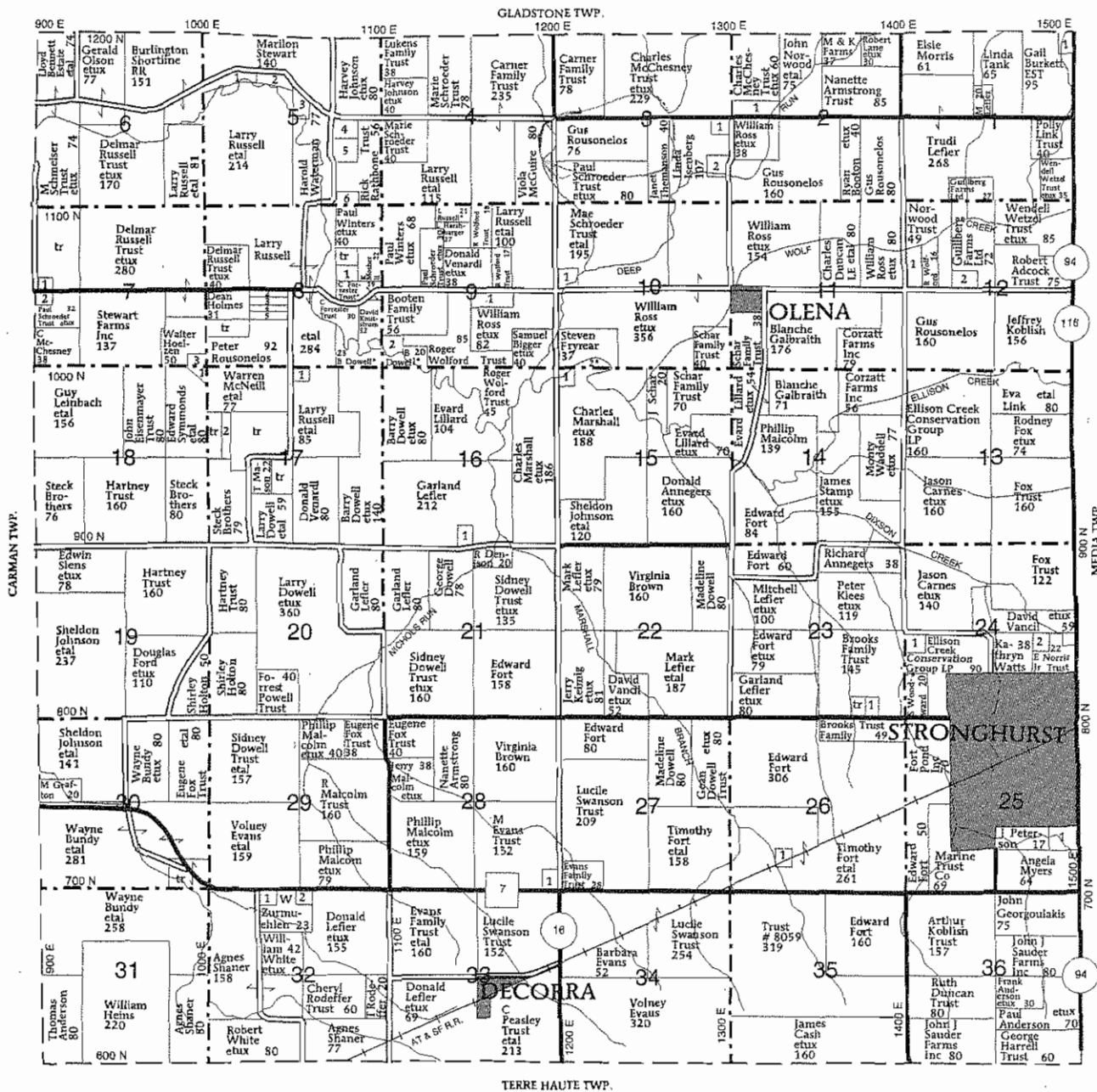

- STRONGHURST TOWNSHIP**
SECTION 1
 1. Larsen, John
SECTION 2
 1. Bruce, Marlon
SECTION 3
 1. Lefary, Herbert
SECTION 5

1. Mynatt, Rex
 2. Coffey Jr, Merle
 3. Meier, Justin
 4. Mynatt, Avery
 5. Dalley, Terrence
 6. Thompson, David
SECTION 7
 1. Meeker, Ed
 2. Fortner, Robert
 3. Rousonelos, Peter
SECTION 8

1. Jacobs, Michael
 2. Kern, Donald
 3. Derby, John
 4. Kern, Donald
 5. M & K Farms
SECTION 9
 1. Sutcliffe Family Trust
SECTION 10
 1. Knutstrom, David
SECTION 11
 1. Moburg, Connie
 2. Marshall, Charles

- SECTION 12**
 1. Earle, John
SECTION 13
 2. Waterman, Clemens
SECTION 15
 1. Sutcliffe Family Trust
SECTION 16
 1. Lefier, Mark
SECTION 17
 1. Adams, Sherri
 2. Duffy, Roxanne
SECTION 18

1. Rousonelos, Peter
SECTION 23
 1. Grafton, Randy
SECTION 24
 1. Swishek, Michael
 2. Village of Stronghurst
SECTION 25
 1. Henderson County Fair Association
SECTION 26
 1. Fryrear, Gary

- SECTION 28**
 1. Evans, Sara
SECTION 32
 1. Dairick, David
 2. Brooks, Douglas

STATE OF ILLINOIS

COUNTY OF SANGAMON

)
)
)
)
)

PROOF OF SERVICE

I, the undersigned attorney at law, hereby certify that on August 25, 2011, I served true and correct copies of an **APPEARANCE AND THE RECOMMENDATION**, upon the persons and by the methods as follows:

[1st Class U.S. Mail]

Steve Santarelli
Illinois Department of Revenue
101 West Jefferson
Post Office Box 19033
Springfield, Illinois 62794

[1st Class U.S. Mail]

Deborah Ann Rousoneles
25925 W. 135th Street
Plainfield, Illinois 60544

[Electronic Filing]

Clerk
Illinois Pollution Control Board
James R. Thompson Center
100 West Randolph Street, Suite. 11-500
Chicago, Illinois 60601

ILLINOIS ENVIRONMENTAL PROTECTION AGENCY

/s/ Vera Herst
Assistant Counsel
Division of Legal Counsel
1021 North Grand Avenue East
P.O. Box 19276-
Springfield, Illinois 62794-9276
217.782.5544
217.782.9143 (TDD)

THIS FILING IS SUBMITTED ON RECYCLED PAPER